

PARTIAL SECT. A-A

SIE MASTER DRAWING
 CHECKED AND APPROVED BY
 PART NAME
 DATE

S. V. FELU
 30.9.99

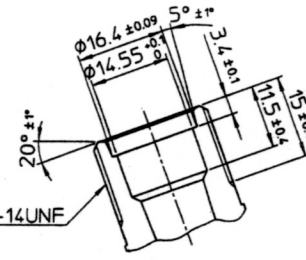

PARTIAL SECT. B-B(2:1)

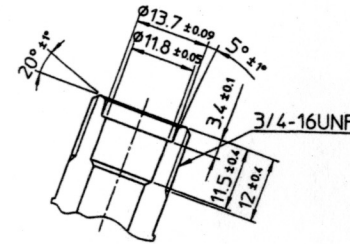

PARTIAL SECT. C-C(2:1)

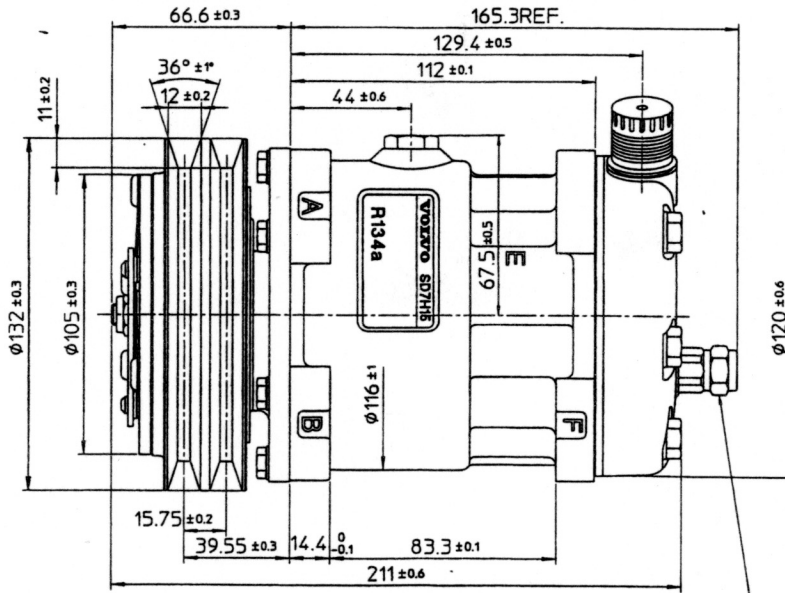

PRESSURE RELIEF VALVE

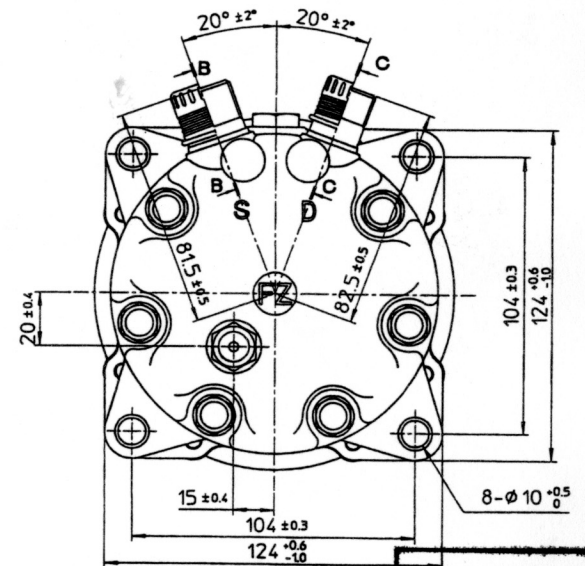

COMPRESSOR SPECIFICATIONS

BORE	φ29.3 mm
STROKE	32.8 mm
DISPLACEMENT PER REVOLUTION	154.9 cc/rev.
ROTATION	CLOCKWISE
NUMBER OF CYLINDERS	7
MAXIMUM ALLOWABLE r.p.m.	7000 r.p.m.
MAXIMUM ALLOWABLE CONTINUOUS r.p.m.	6000 r.p.m.
REFRIGERANT	R134a
OIL : SP-10 OR EQUIV.	240 cc
WEIGHT	kg

CLUTCH SPECIFICATIONS

RATED VOLTAGE	DC 24 V
BREAKAWAY TORQUE	3.5 kg-m
MINIMUM ENGAGEMENT VOLTAGE	16 V MAX.
POWER CONSUMPTION	42 W (CU)
MAXIMUM ALLOWABLE r.p.m.	7000 r.p.m.
MAXIMUM ALLOWABLE CONTINUOUS r.p.m.	6000 r.p.m.
BELT TYPE	A TYPE
PULLEY DIAMETER	φ132 mm
WEIGHT	kg

BOLT SURFACE TREATMENT SPECIFICATION

Fe/Zn 5μ BLACK CROMATE

PRESSURE RELIEF VALVE SPECIFICATION

RELIEVED PRESSURE : 38±3bar

SEE UNCONTROLLED COPY
 FOR INFORMATION ONLY
 INITIAL *MT*
 DATE 18/5/01

NOTE

THIS COMPRESSOR IS SD7H15 TYPE C.

MATERIAL	PART NO.	8069	NAME	COMPRESSOR
THIRD ANGLE PROJECTION	SCALE	1:1	MODEL	SD7H15FZ8069
DESIGNED BY <i>Y. A. 97.6.10</i>	DATE	10 June 1997	DRAWING NO.	8069 - 6000
CHECKED BY <i>Y. A. 97.6.10</i>	DATE	10 June 1997	REVISION RECORD	
APPROVED BY <i>Y. A. 97.6.10</i>	DATE	10 JUN 1997		