

PERSON	REV.	APPV. DATE	REVISIONS	DWN	ESGN	CHK	APPV.
			INITIAL ISSUE				

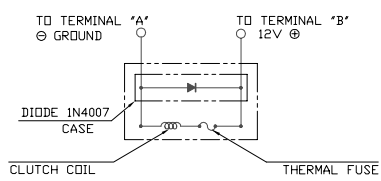

**CIRCUIT DIAGRAM**  
(FOR REFERENCE)

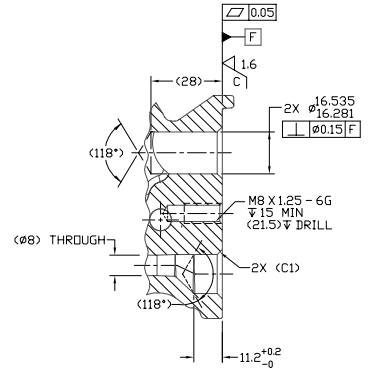

**SECTION B-B**  
(SHIPPING PAD AND BOLT REMOVED)

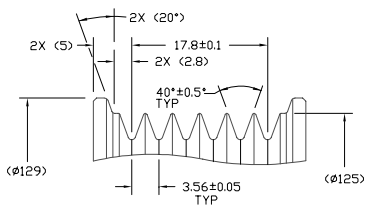

**DETAIL C**  
SCALE 2:1

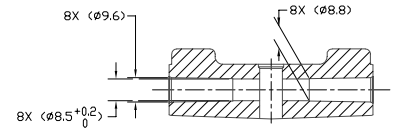
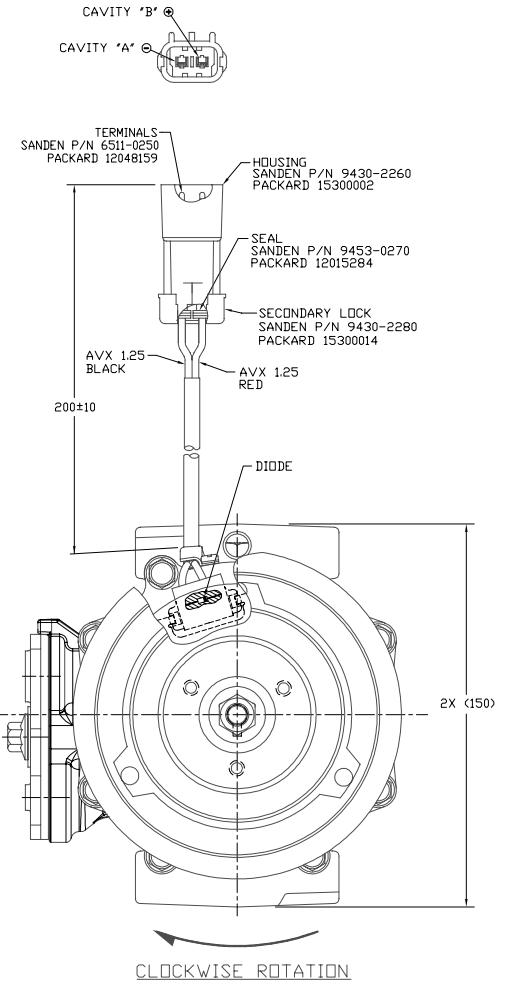

**SECTION A-A**

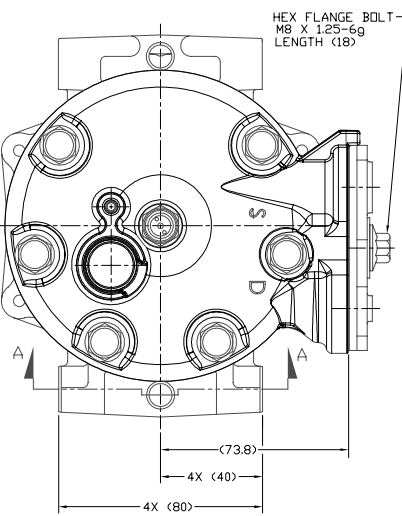

**COMPRESSOR SPECIFICATIONS (REF.)**

DISPLACEMENT PER REVOLUTION	154.9 cc / rev. ( 9.5cuin. / rev. )
MAXIMUM ALLOWABLE R.P.M.	6000 R.P.M.
MAXIMUM ALLOWABLE CONTINUOUS R.P.M.	4000 R.P.M.
REFRIGERANT	R134a
OIL ( SP-15 )	300 cc ( 10.1 fl.oz. )

**CLUTCH SPECIFICATIONS (REF.)**

RATED VOLTAGE	DC 12V
BREAKAWAY TORQUE	3.5 kgf-m min. @ 12V
MINIMUM ENGAGEMENT VOLTAGE	7.5V @ AIR GAP 0.6mm
POWER CONSUMPTION	49 watts max.
BELT TYPE	PV6 TYPE
MAXIMUM ALLOWABLE BELT TENSION	120 kgf
PULLEY DIAMETER	$\phi 125$ mm ( 4.92 in. )
CLUTCH TYPE	HEAVY DUTY

NOTE:  
1. DIMENSIONS ARE TO VIRTUAL SHARP CORNERS UNLESS OTHERWISE SPECIFIED.

**DO NOT SCALE**

REV. LEVEL	RELEASED FOR PRODUCTION	<p><b>SANDEN</b> SANDEN INTERNATIONAL, U.S.A., INC.</p> <p>This drawing and the information contained herein are CONFIDENTIAL and PROPRIETARY to Sanden International (U.S.A.), Inc. and are received in CONFIDENCE and shall not be used, copied, or disclosed to others without the written permission of Sanden International (U.S.A.), Inc.</p> <p>INTERPRETATION OF THIS DRAWING PER ASME Y14.5M-1994</p> <p>THIRD ANGLE PROJECTION</p> <p>MATERIAL: <math>\phi</math> <math>\leftarrow</math> <math>\leftarrow</math> <math>\leftarrow</math></p> <p>NAME: <b>COMPRESSOR</b></p> <p>DWG. NO. <b>4023-6000</b></p>	SIZE		
A	DESIGN DEVELOPMENT		SCALE REF. 1:1	PLOTTED	METRIC
DRAWN	Cristy Wolff		DATE	1/1/07	DATE
CHK.	J Sokolowski		DESIGN VALIDATION		
APPV.	Steve Lee 1/1/07		RELEASED FOR PRODUCTION		
APPV.	Steve Marthel		DATE	1/1/07	DATE
REV. LEVEL	RELEASED FOR PRODUCTION		DATE	1/1/07	DATE
APPV.	Steve Marthel		DATE	1/1/07	DATE
APPV.	Steve Marthel		DATE	1/1/07	DATE
APPV.	Steve Marthel		DATE	1/1/07	DATE